

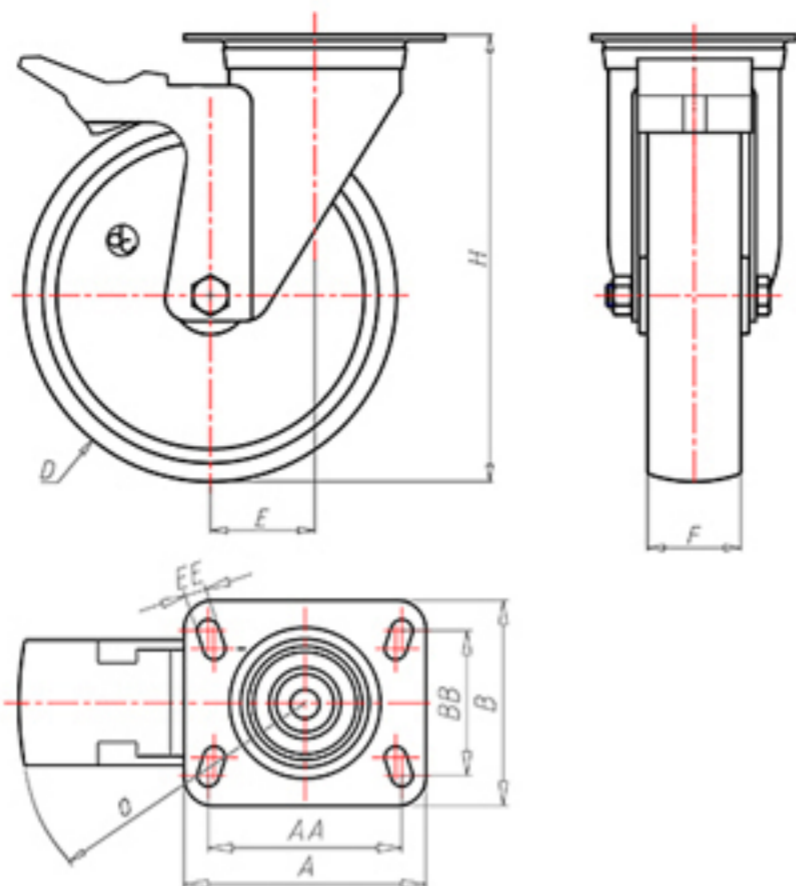

82 Shore A
+90°C
-40°C



	D	150
	F	40
	H	181
	AxB	100x85
	AAxBB	80x60
	EE	9
	E	46
	O	124
	LC	250



Code for plain bore wheel

XSGZ15045FA

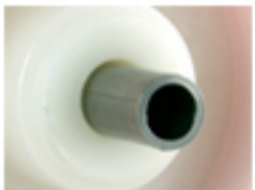

Code for wheel with Inox roller bearing

XSGZ15045RFA



Code for wheel with double sealed ball bearing

XSGZ15045CFA



Code for wheel with double sealed Inox ball bearing

—

