

D-FLEX

82 Shore A
+90°C
-40°C

INOX

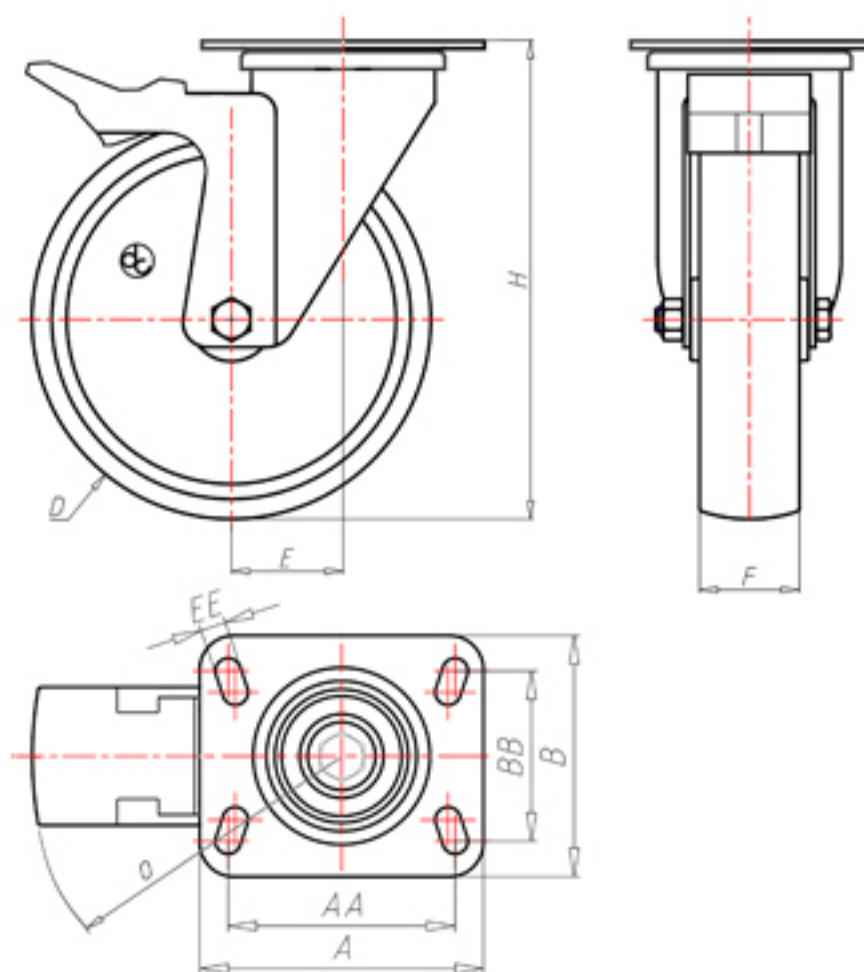

	D	80
	F	33
	H	110
	AxB	100x85
	AAxBB	80x60
	EE	9
	E	40
	O	124
	LC	210



Code for plain bore wheel

XSGX8040PFA



Code for wheel with roller bearing

XSGX8040PRXFA



Code for wheel with double sealed ball bearing

XSGX8040PCFA



Code for wheel with double sealed Inox ball bearing

XSGX8040PCXFA

