

D-FLEX

82 Shore A
+90°C
-40°C

INOX

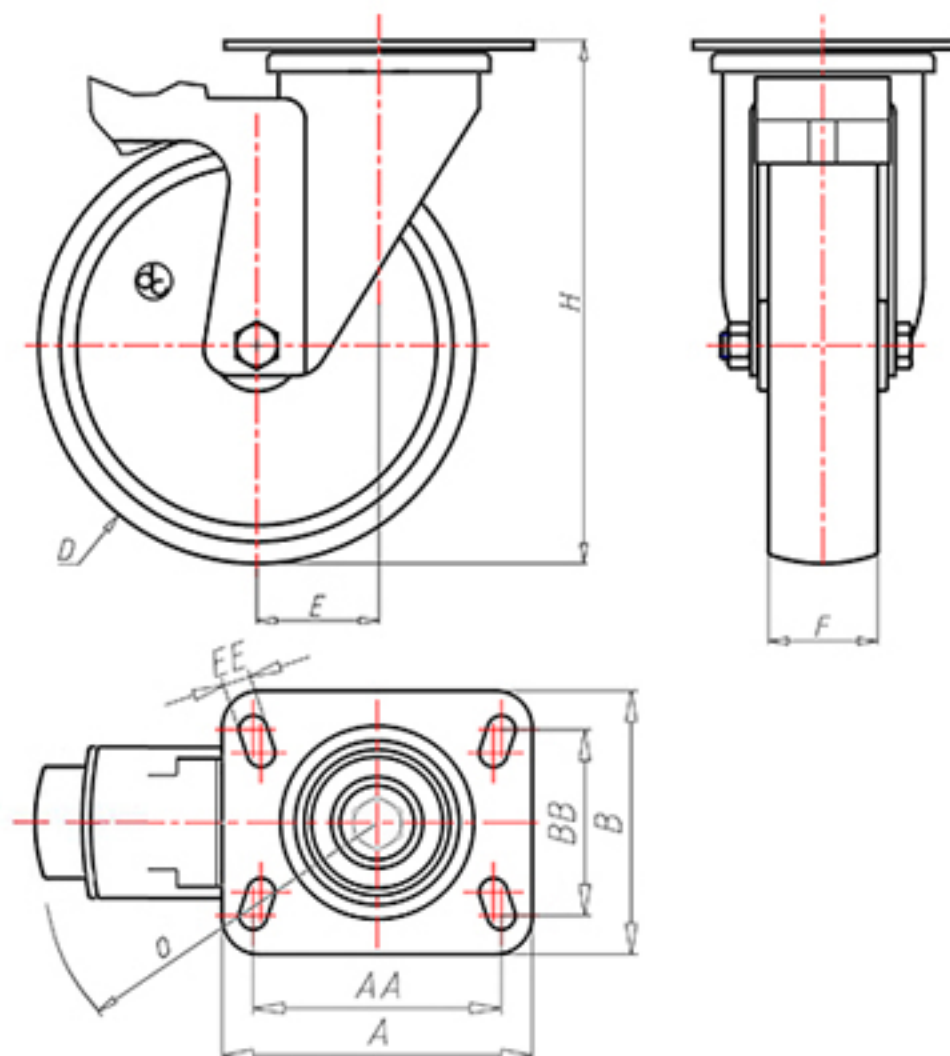

| | | |
|--|-------|--------|
| | D | 125 |
| | F | 35 |
| | H | 158 |
| | AxB | 100x85 |
| | AAxBB | 80x60 |
| | EE | 9 |
| | E | 44 |
| | O | 104 |
| | LC | 260 |



Code for plain bore wheel

XSGX12545PFS



Code for wheel with Inox roller bearing

XSGX12545PRXFS



Code for wheel with double sealed ball bearing

XSGX125PCFS



Code for wheel with double sealed Inox ball bearing

XSGX125PCXFS

