

D-FLEX

82 Shore A
+90°C
-40°C

INOX

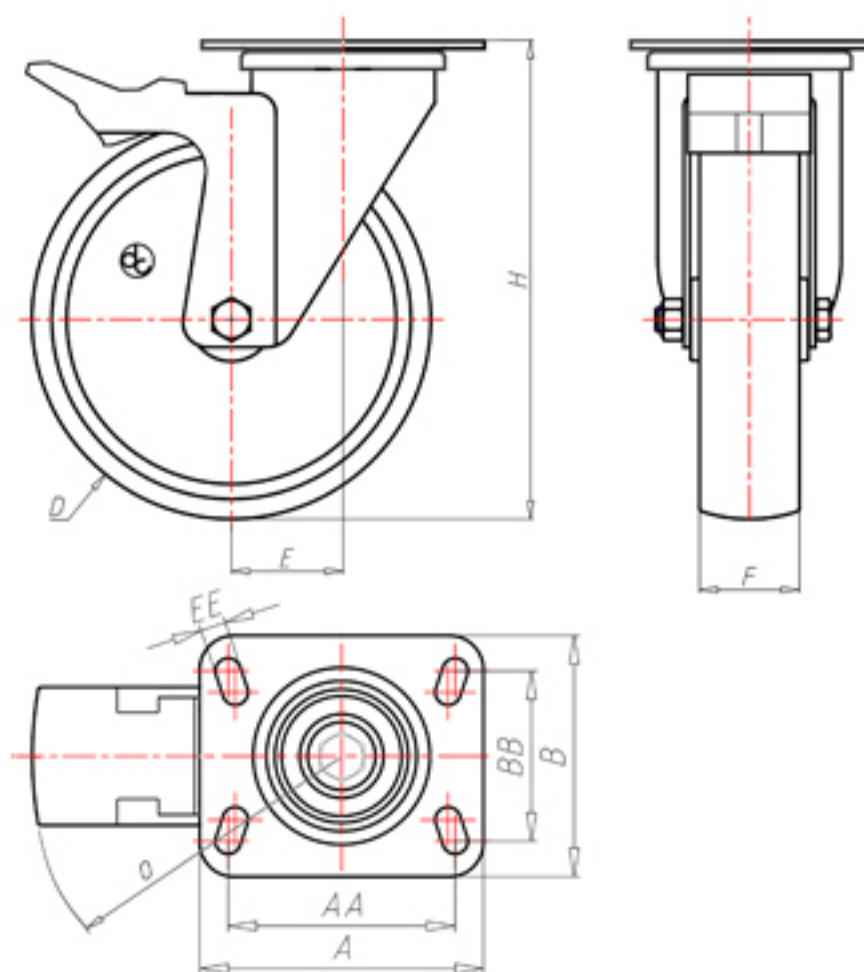

	D	100
	F	33
	H	131
	AxB	100x85
	AAxBB	80x60
	EE	9
	E	42
	O	124
	LC	250



Code for plain bore wheel

XSGX10045PFA



Code for wheel with Inox roller bearing

XSGX10045PRXFA



Code for wheel with double sealed ball bearing

XSGX100PCFA



Code for wheel with double sealed Inox ball bearing

XSGX100PCXFA

