

D-FLEX

82 Shore A
+90°C
-40°C

INOX

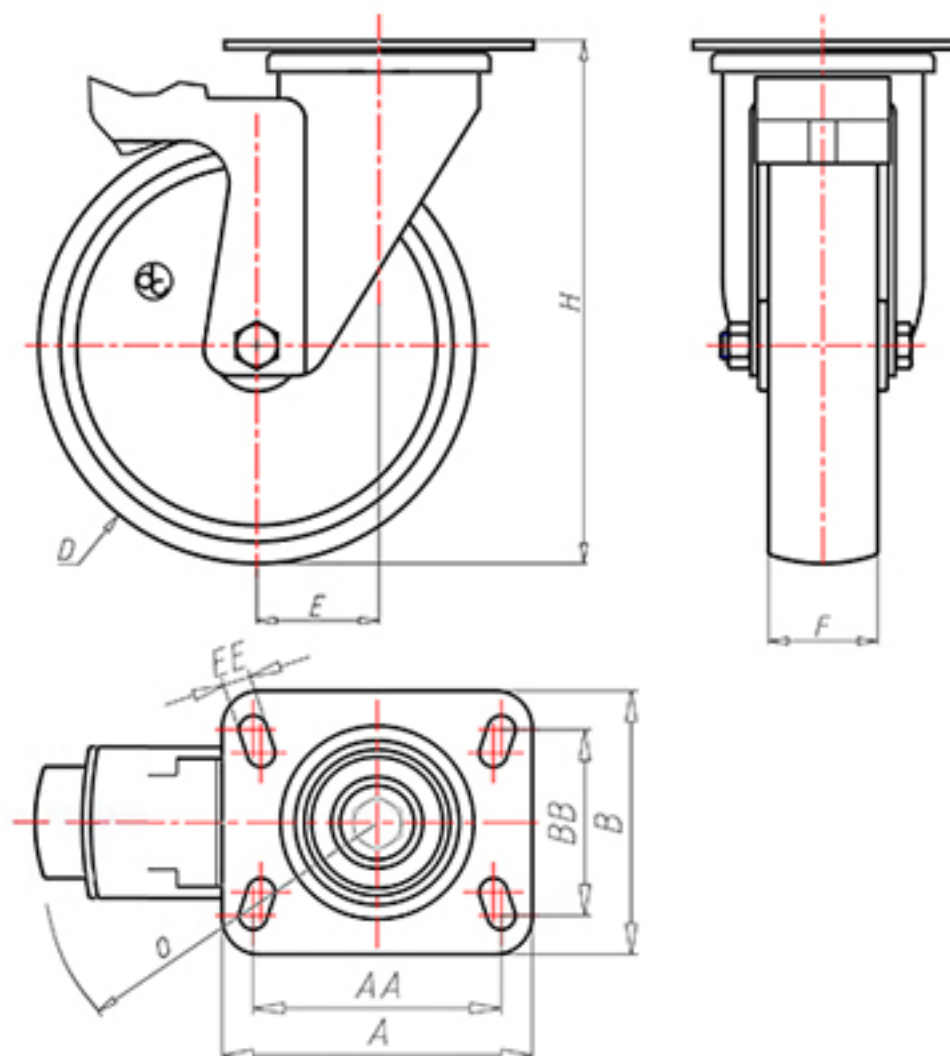

	D	100
	F	33
	H	131
	AxB	100x85
	AAxBB	80x60
	EE	9
	E	42
	O	104
	LC	250



Code for plain bore wheel

XSGX10040PFS



Code for wheel with Inox roller bearing

XSGX10040PRXFS



Code for wheel with double sealed ball bearing

XSGX10040PCFS



Code for wheel with double sealed Inox ball bearing

XSGX10040PCXFS

