

D-FLEX

82 Shore A  
+90°C  
-40°C

INOX

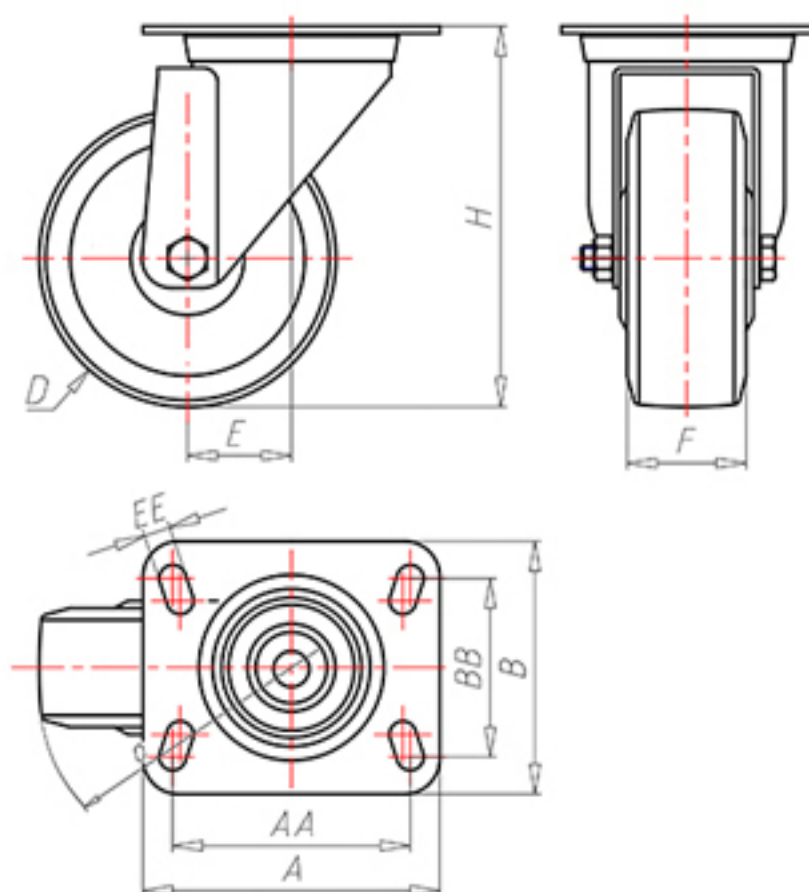

	D	100
	F	33
	H	128
	AxB	100x85
	AAxBB	80x60
	EE	9
	E	42
	O	92
	LC	220



Code for plain bore wheel

XSGX10040



Code for wheel with Inox roller bearing

XSGX10040RX



Code for wheel with double sealed ball bearing

XSGX10040C



Code for wheel with double sealed Inox ball bearing

XSGX10040CX

