

D-NAMIC

92 Shore A
+90°C
-40°C

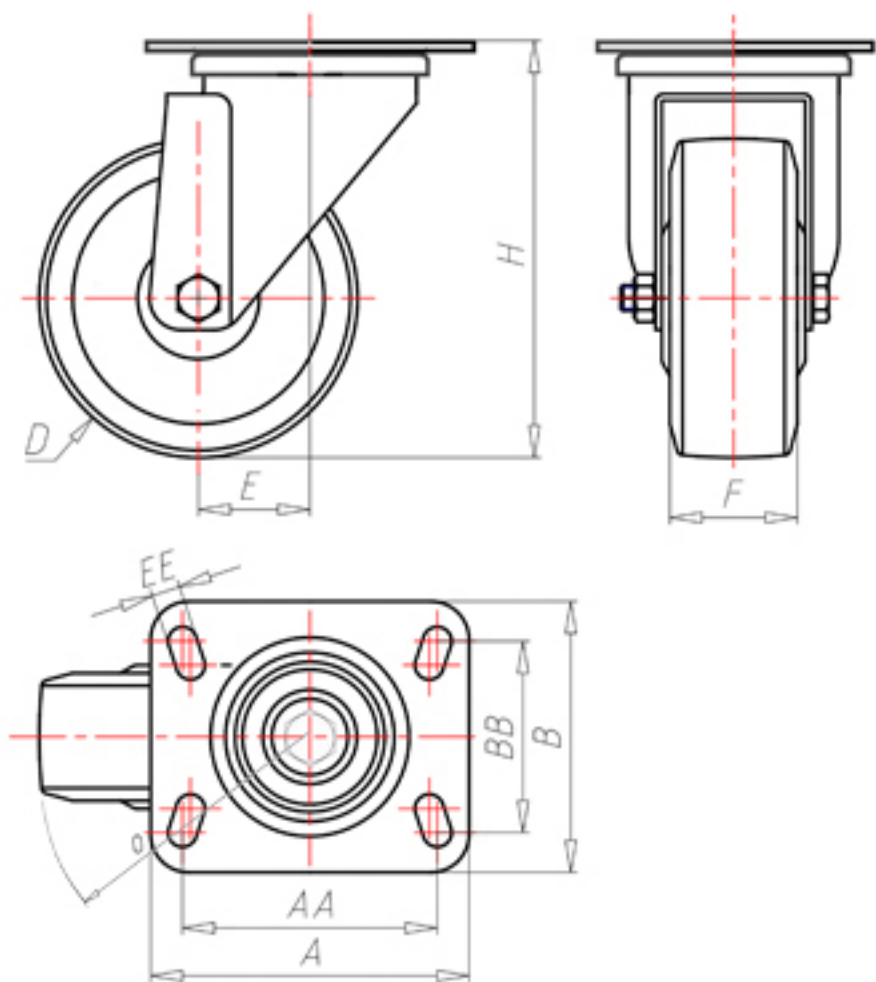

	D	150
	F	40
	H	184
	AxB	100x85
	AAxBB	80x60
	EE	9
	E	46
	O	107
	LC	280



Code for plain bore wheel
XNGZ15045P

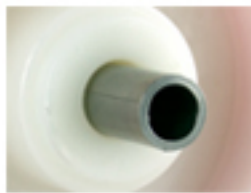

Code for wheel with roller bearing
XNGZ15045PR



Code for wheel with double sealed ball bearing
XNGZ15045PC



Code for wheel with double sealed Inox ball bearing
-

