

D-NAMIC

92 Shore A
+90°C
-40°C

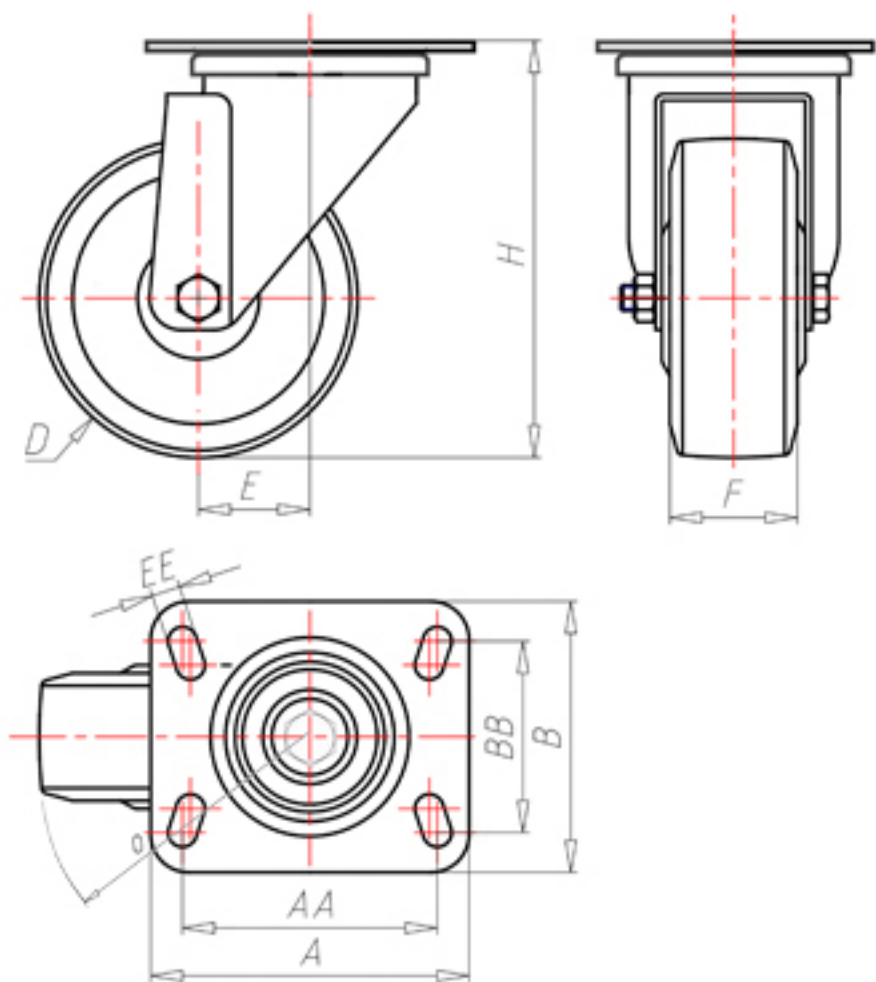

	D	125
	F	35
	H	158
	AxB	100x85
	AAxBB	80x60
	EE	9
	E	44
	O	107
	LC	260



Code for plain bore wheel

XNGZ12545P

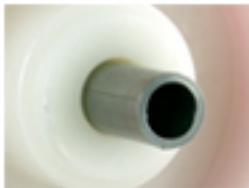

Code for wheel with roller bearing

XNGZ12545PR



Code for wheel with double sealed ball bearing

XNGZ125PC



Code for wheel with double sealed Inox ball bearing

-

