

**D-FLEX**

82 Shore A  
+90°C  
-40°C

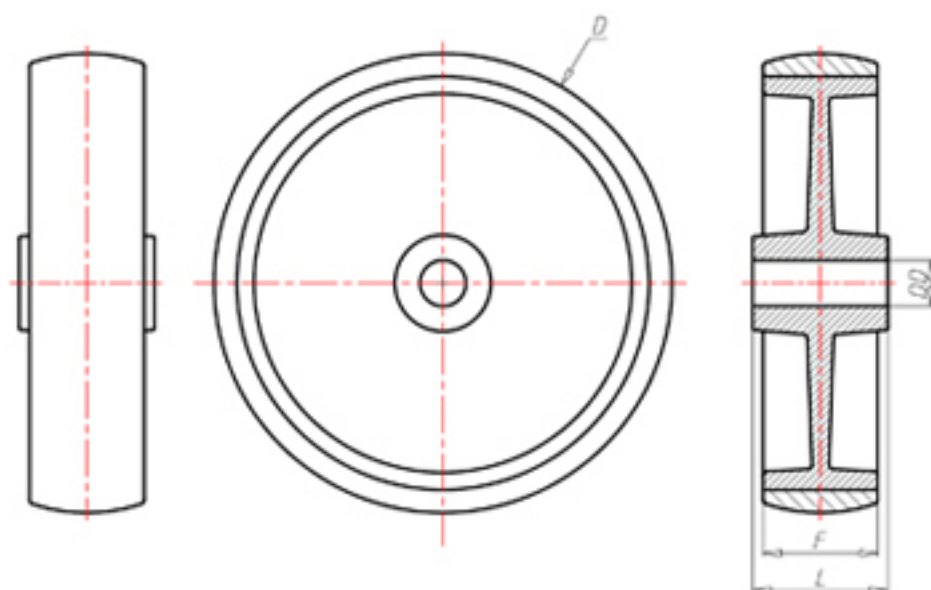

	D	100
	F	33
	L	40
	DD	Ø 12
	LC	280



Code for plain bore wheel

**PXS10040**

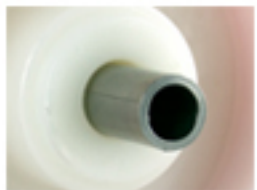

Code for wheel with roller bearing

**PXS10040R**



Code for wheel with Inox roller bearing

**PXS10040RX**



Code for wheel with double sealed ball bearing

**PXS10040C**



Code for wheel with double sealed Inox ball bearing

**PXS10040CX**

