

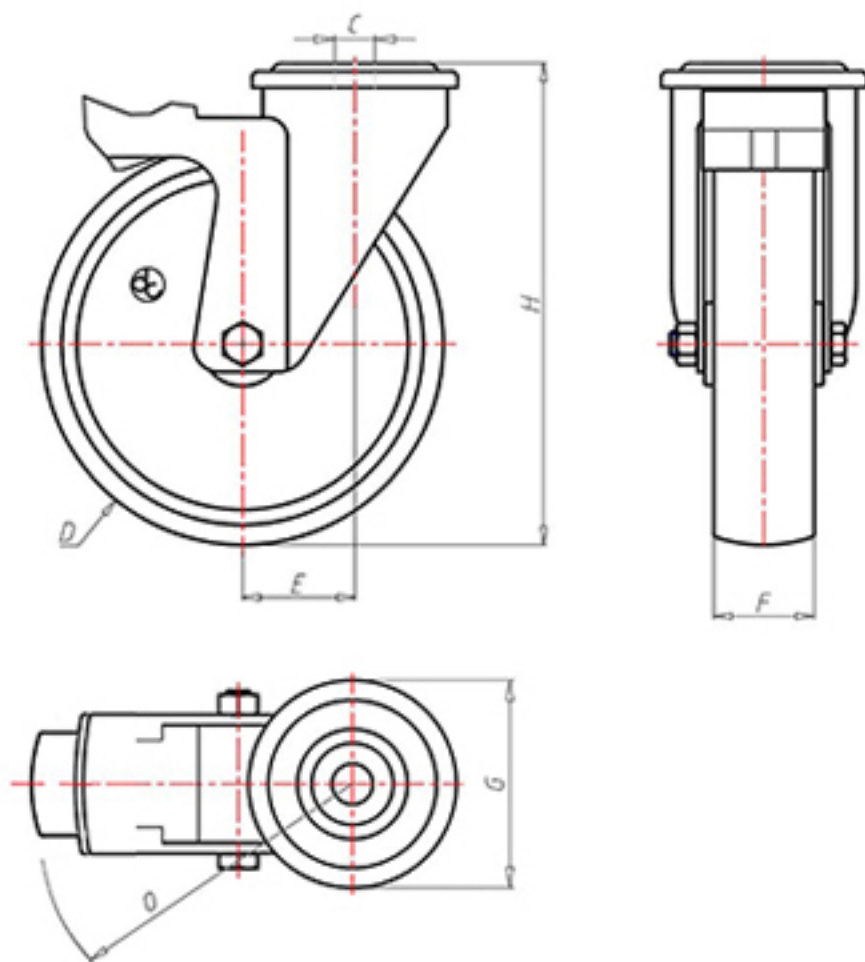

+150°C
-40°C



| | | |
|--|--------------------|------|
| | D | 100 |
| | F | 35 |
| | H | 128 |
| | G | Ø 77 |
| | C | Ø 12 |
| | E | 42 |
| | O | 124 |
| | Kg weight LC | 220 |



Code for plain bore wheel

LPX10040FS



Code for wheel with coated bush

LPX10040BRFS



Code for wheel with double BT self-lube bush

LPX10040BTFS



Code for wheel with double HT ball bearing

-

