

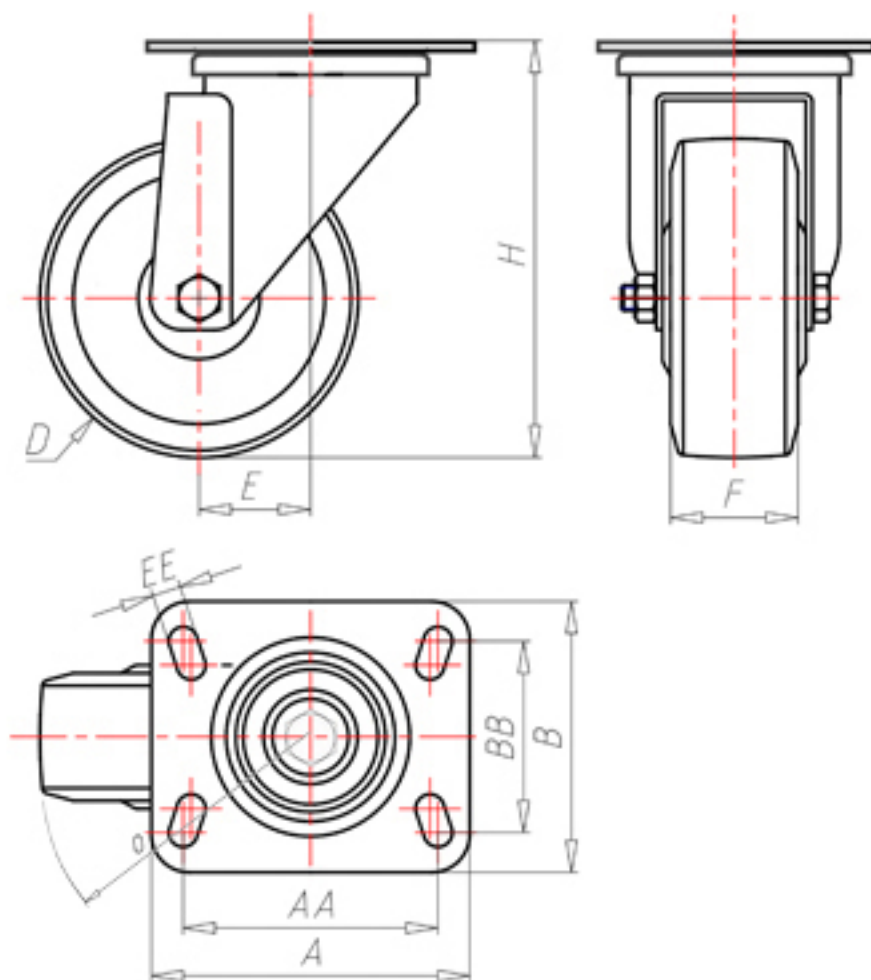

+150°C  
-40°C



	D	80
	F	35
	H	110
	AxA	100x85
	AAxBB	80x60
	EE	9
	E	42
	O	82
	LC	230



Code for plain bore wheel

**LGZ8040P**



Code for wheel with coated bush

**LGZ8040PBR**



Code for wheel with double BT self-lube bush

**LGZ8040PBT**



Code for wheel with double HT ball bearing

-

