

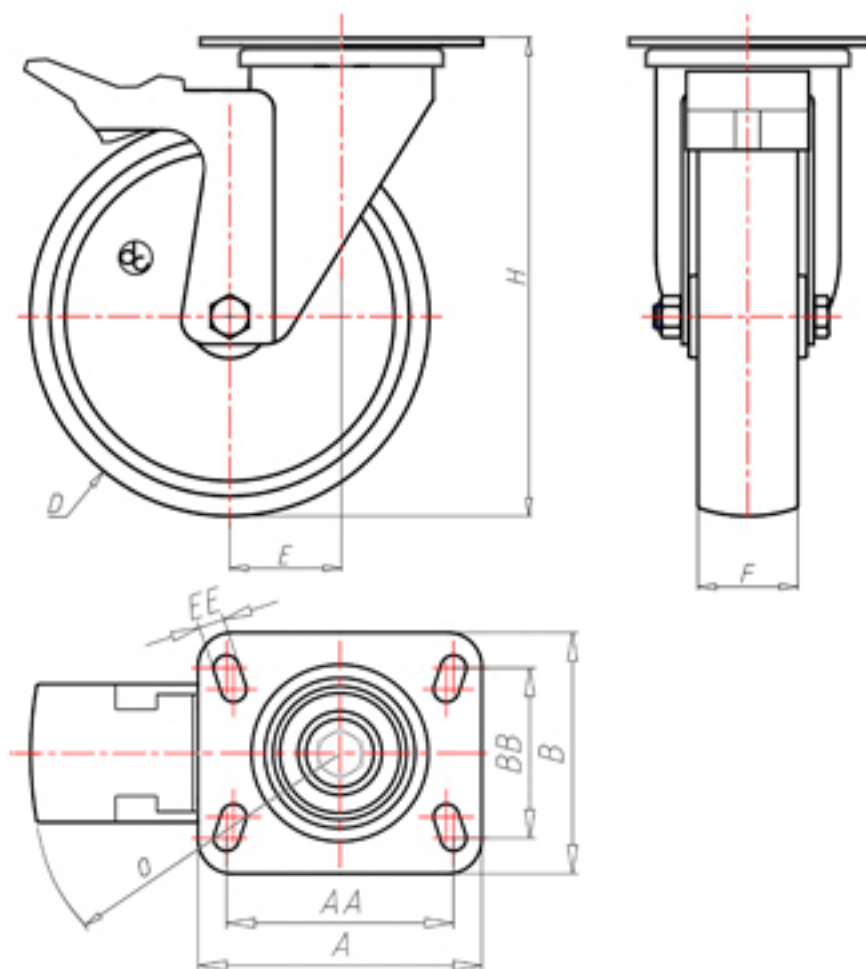

+150°C
-40°C



	D	80
	F	35
	H	110
	AxA	100x85
	AAxBB	80x60
	EE	9
	E	40
	O	124
	LC	230



Code for plain bore wheel

LGZ10040PFA



Code for wheel with coated bush

LGZ10040PBRFA



Code for wheel with double BT self-lube bush

LGZ10040PBTFA



Code for wheel with double HT ball bearing

-

