

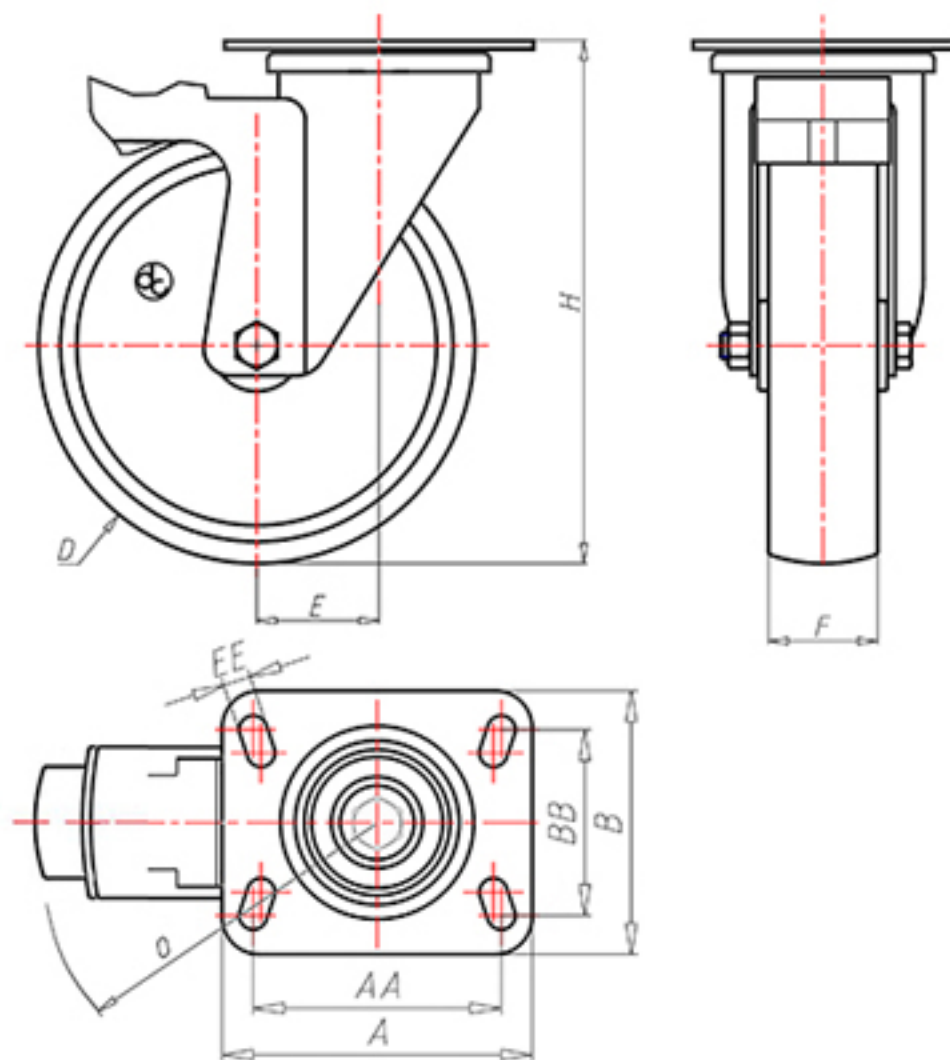

+150°C
-40°C



	D	80
	F	35
	H	110
	AxA	100x85
	AAxBB	80x60
	EE	9
	E	42
	O	124
	LC	230



Code for plain bore wheel

LGX8040PFS



Code for wheel with coated bush

LGX8040PBRFS



Code for wheel with double BT self-lube bush

LGX8040PBTFS



Code for wheel with double HT ball bearing

-

