

**DITHERM  
LTW**

+150°C

-40°C

**INOX**

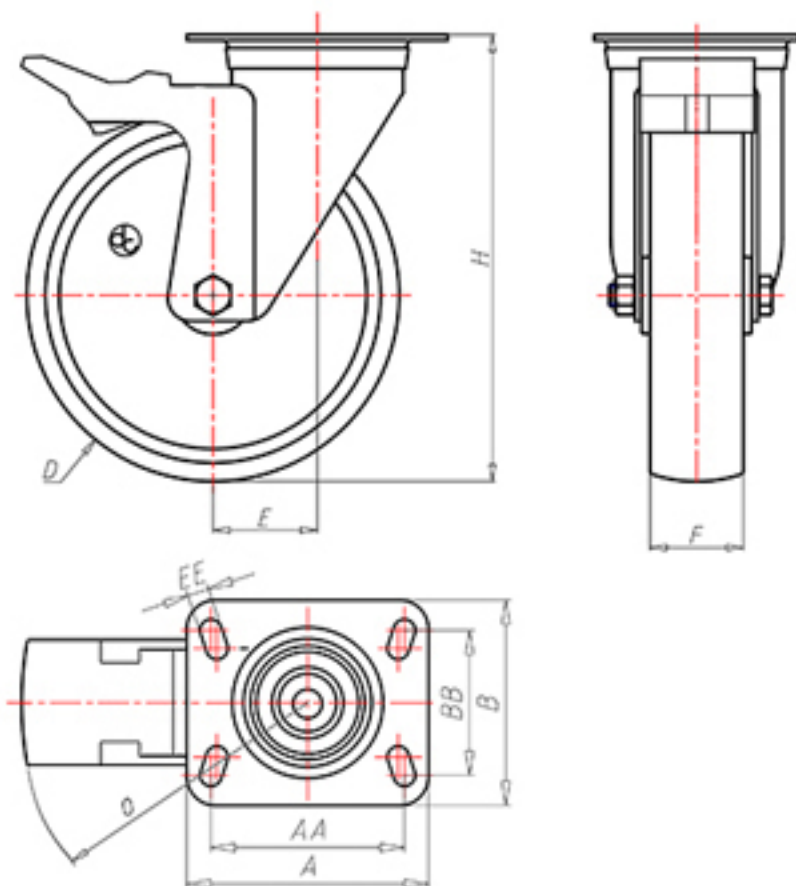

	D	150
	F	40
	H	181
	AxA	135x110
	AAxBB	105x80
	EE	11
	E	52
	O	124
	LC	350



Code for plain bore wheel

**LGX15060FA**



Code for wheel with coated bush

-



Code for wheel with double BT self-lube bush

-



Code for wheel with double HT ball bearing

-

