

**DITHERM  
LTW**

+150°C  
-40°C

**INOX**

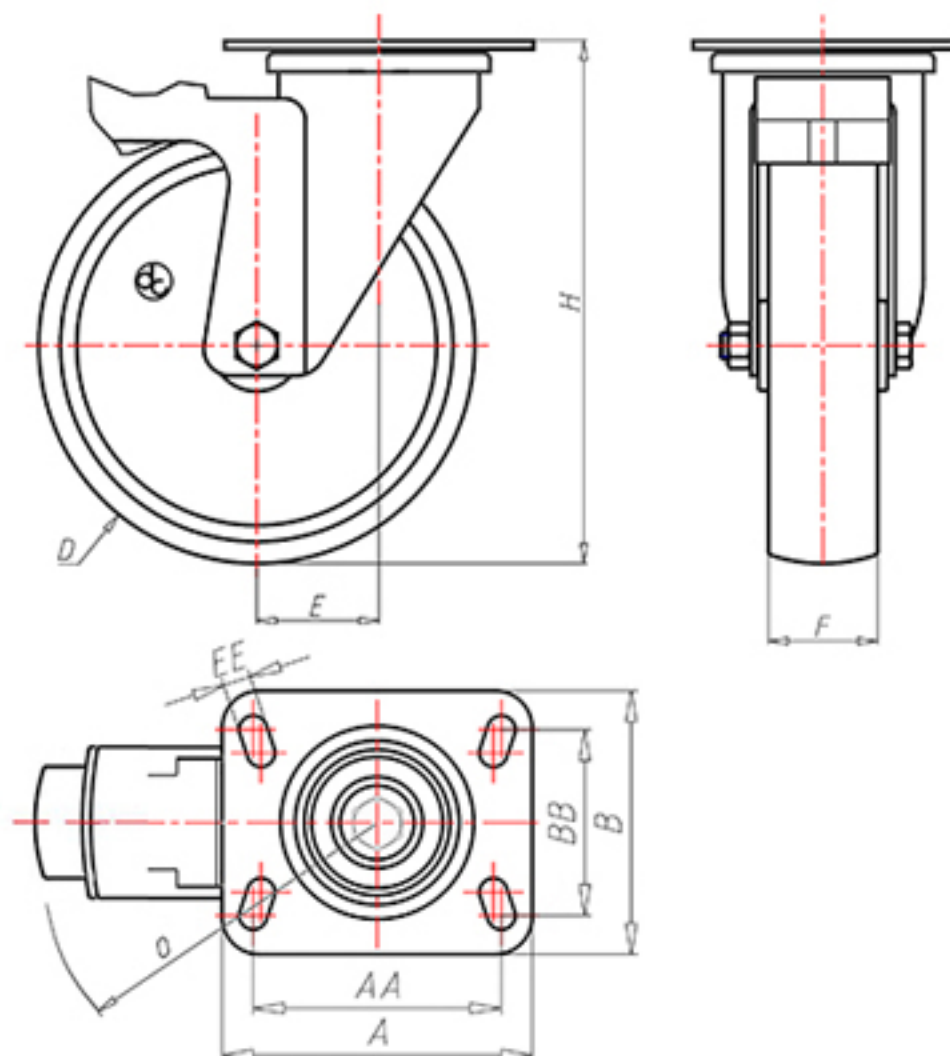

	D	100
	F	35
	H	131
	AxA	100x85
	AAxBB	80x60
	EE	9
	E	42
	O	124
	LC	250



Code for plain bore wheel

**LGX10040PFS**



Code for wheel with coated bush

**LGX10040PBRFS**



Code for wheel with double BT self-lube bush

**LGX10040PBTFS**



Code for wheel with double HT ball bearing

-

